

- » Trolley
- » Assembly Table
- » Work Bench
- » Inspection Table
- » Tool Cabinet
- » Work Table
- » Racks
- » Slotted Angle Rack
- » Computer Cabinet
- » Canteen Table
- » Chip Trolley
- » Pallets
- » CNC Tool Storage System
- » Industrial Lockers
- » Gravity Conveyors
- » Soft & White Board With Stand
- » Platform's
- » File Cabinet
- » S S Fabrication Services
- » Display Board A4 Size
- » Office Cupboard
- » Library Cupboard

**PRODUCT  
CATALOGUE**

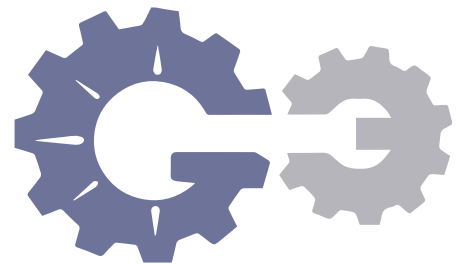

# GENIOUS ENGINEERING

Turning ideas into reality

SINCE: 2010

# GENIOUS ENGINEERING

For the past 10 years, Genious Engineering has been the unprecedented leader in the Indian market in terms of storage solutions and material handling. Our work is an extension of our motto, "Turning Ideas Into Reality". As far as we are concerned, it is not just a motto, it is our way of life.

## **Customized product solutions**

Along with the conventional solution to problems we also offer innovative ideas to efficiently solve a complication. Some of our products include:

- » Various types of automated equipment and machinery
- » Variety of lifting apparatus
- » Different types of conveyors
- » A plethora of welding machinery and equipment

## **Shop floor area**

Unlike competition, we do not waste time in shuttling goods between different operations. Our shop floor capacity ensures that we are able to execute most operations in-house without having to worry about the risk of transit.

- » 5,000 square feet space capable of handling in-house operations.
- » 20 feet high.

## **Available welding operations**

To be done right, each material has to be welded using a specific process that depends on the composition of the material and the nature of its use. In addition to having a variety of methods at our disposal, we also have the expertise to identify and perform the best process to suit your needs.

- » CO2 welding machine
- » Arc welding machine
- » Argon welding facility

## **Shearing and bending facilities**

Shearing and bending are two of our most-used facilities. We are proud to tell you that we possess potent machinery to handle even the most intensive of tasks.

- » Mechanical shearing machine (capacity 4 m x 6 mm thickness)
- » Hydraulic bending machine (capacity 4 m x 4 mm thickness)

## **Powder-coating**

The finest quality of powder-coat boasts of having a finish that is bereft of blemishes. Our in-house seven-tank process ensures that you get the best result possible.

## **Measuring Instruments**

We provide measuring solutions courtesy of a plethora of measuring equipment.

## **Product Design**

If you are unsatisfied with an existing product in the market, rest assured, for we can help you create your own.

- » All types of customized and standard products
- » Design facility available by using CATIA and AutoCAD software

## **Material Delivery Facility Available**

## **After-sales Service Available**

## **Material test certificates also available**

## ASSEMBLY TABLE / INSPECTION TABLE

### TYPE

Modular Or Welded

### LOAD CAPACITY

250kg UDL MAX at top

### SIZES

1500 L X 700 W X 850 MM HT & 2150 HT  
1200 L X 700 W X 850 MM HT & 2150 HT  
1000 L X 700 W X 850 MM HT & 2150 HT  
1800 L X 700 W X 850 MM HT & 2150 HT  
2000 L X 700 W X 850 MM HT & 2150 HT  
700 L X 700 W X 850 MM HT & 2150 HT

#### » SINGLE DRAWER UNIT

Size: 365 L x 460 D x 135 HT

Drawer Usable Space: 315 L x 460 D x 85 HT

#### » DOUBLE DRAWER UNIT

Size: 365 L X 460 D X 240 HT

Drawer Usable Space: 315 L x 460 D X 85 HT

#### » THREE DRAWER UNIT

Size: 365 L X 460 D X 345 MM HT

Drawer Usable Space: 315 L X 460 D X 85 MM HT

### FINISH

M S Powder Coated



» SINGLE DRAWER  
UNIT

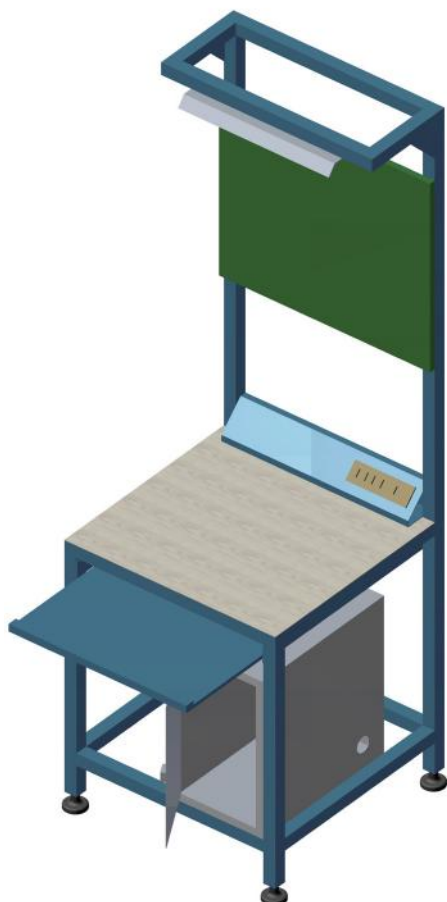
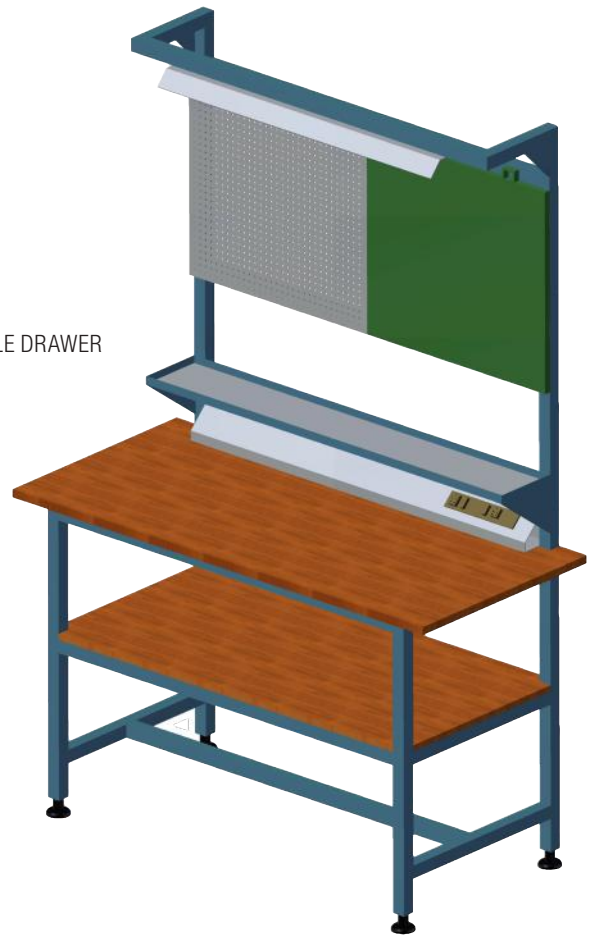

### APPLICATION

station of assembly of various components  
as well as work for computer also

### LOAD CAPACITY

200 UDL MAX at top

### SIZE

700X 700 W X 850 MM HT &  
2150 MM HT TOTAL

### HINGE DOOR CABINET FOR CPU OR UPS

Size: 640 L X 500 W X 500 MM HT

### FINISH

M S Powder Coated

## COMPUTER TABLE WITH SOFT PIN BOARD

- » WORK BENCH  
WITH DRAWER UNIT & CABINET  
Size: 1125 L x 500 D x 850 MM HT  
Cabinet Cabinet Size:  
315 L X 460 D x 560 MM HT

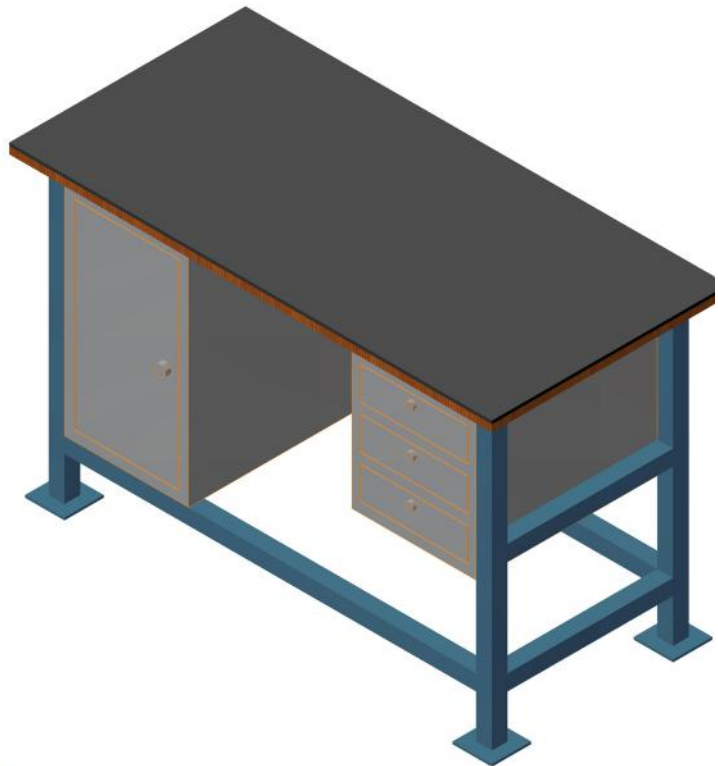

- « WORK BENCH  
WITH DECKING PANEL LIGHT DUTY  
Size: 1125 L x 500 D x 850 MM HT

- » WORK BENCH  
WITH DECKING PANEL & DRAWER UNIT  
Size: 1200 L x 750 W x 850 MM HT  
Drawer Usable space:  
315 L x 460 D x 85 HT





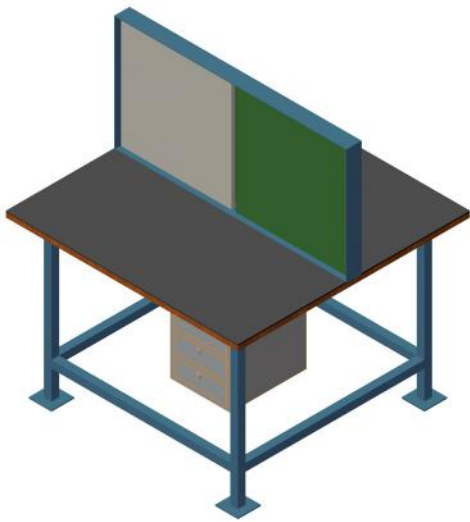

» WORK BENCH TWO SIDED  
WHITE BOARD & SOFT BOARD

Size: 1220 L x 1220 W x 800 MM HT

Drawer Usable space  
315 L x 460 D x 85 MM HT

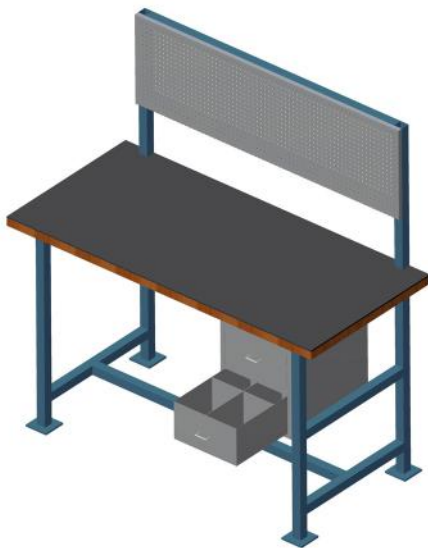

» WORK BENCH  
WITH PERFO PANEL & DRAWER UNIT

Size: 1500 L x 700 D x 2150 mm HT

Drawer Usable space  
315 L x 460 D x 85 HT

» WORK BENCH WITH CABINETS ON BOTH SIDES

Size: 1500 L x 750 D x 1000 MM HT

Cabinet Size: 315 L x 460 D x 560 MM HT

## WORK BENCH

(for assembly work & maintenance work at shop floor site)

### Load Capacity

500/1000kg UDL max at top.

### Sizes

1) 1500 L X 700 w X 850 MM HT

2) 2000 L X 700 w x 850 MM HT

3) 1800 L X 700 w x 850 MM HT



## COOLANT DRUM STORAGE STACKABLE PALLET

### APPLICATION

To Storage of drum with tray  
for oil leakage

### LOAD CAPACITY

Two drum storage of 200 Ltr.  
Drum size: 580 Dia x 875 Mm Ht

### SIZE

1740 L X 955 W X 770 MM HT &  
WITH STACK 910 MM HT

### FINISH

M S Powder Coated

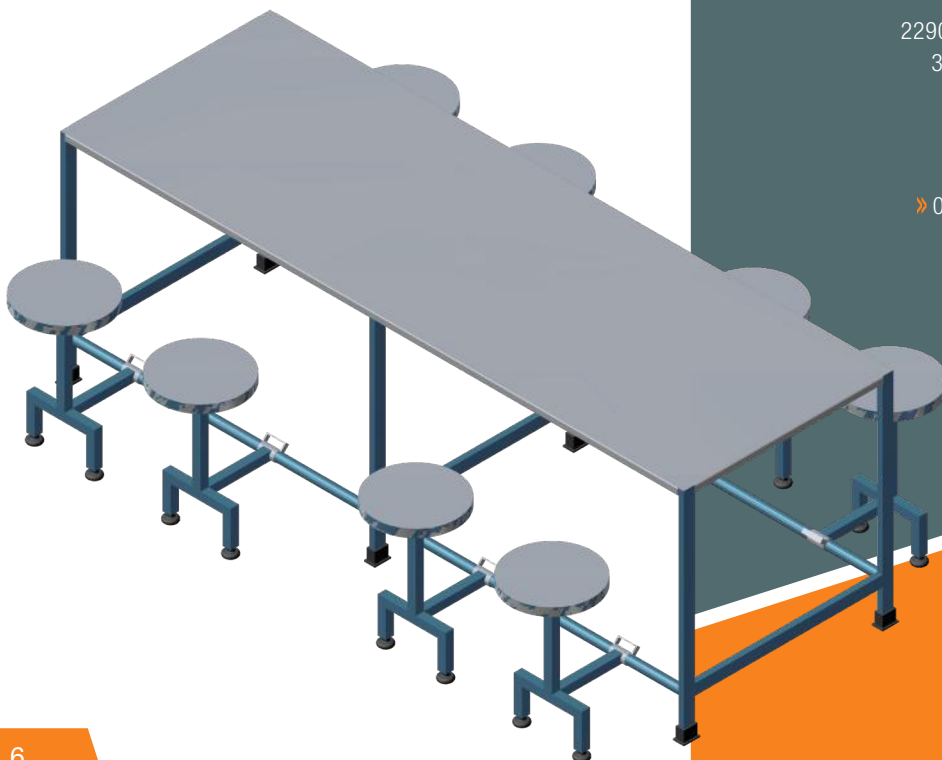
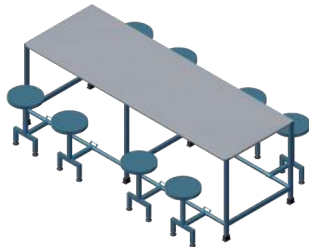
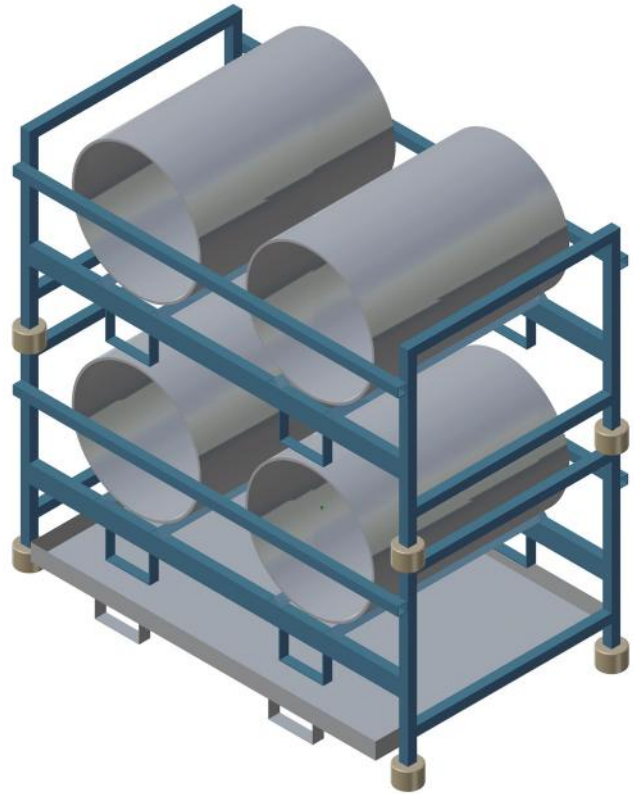

### APPLICATION

For purpose of (meal) dinner or lunch at company

### CAPACITY

8 Persons

### SIZE

2290 L X 770 W X 800 MM HT TABLE HT  
300 MM DIA X 500 MM HT STOOL HT

### ACCESSORIES

- » Leveler for stool
- » Rubber Bush for Table
- » 08.No.stools so that 8 person's can sit
- » Stool can slide inside the table

### FINISH

S.S 304 S.S 202, or M.S.  
Mat or Mirror finish or  
if M.S Powder coated

## CANTEEN TABLE

## SIMPLE PLATFORM TROLLEY

### APPLICATION

To carry different type of material

### TYPE

Fixed Handel or Foldable Handel

### LOAD CAPACITY

150, 200, 500kg UDL MAX at top

### SIZE

425L X 325 D X 1000 MM HT

625 L X 425 D X 1000 MM HT

855 L X 615 D X 1000 MM HT

1275 L X 815 D X 1000 MM HT

### WHEEL

Dia 100 x 35 for 200 kg

Dia 100 x 50 for 500 kg

### FINISH

S.S 202, S.S 304, M S Powder Coated

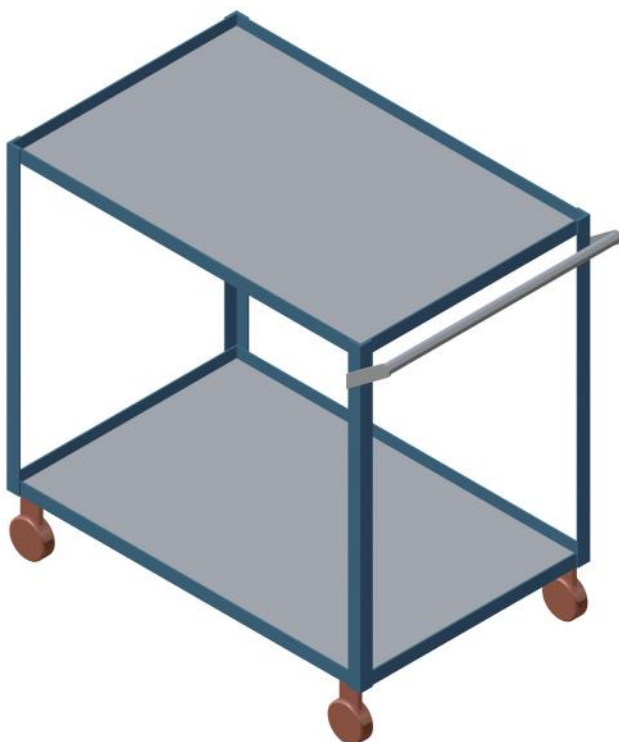

### APPLICATION

To carry different type of material

### LOAD CAPACITY

200, 500 kg max at total trolley

### SIZE

800 L X 500 D X 1000 MM HT

1000 L X 650 D X 1000 MM HT

1250 L X 650 D X 1000 MM HT

### WHEEL

DIA 100 X 35 FOR 200 KG

DIA 150 X 40 FOR 500 KG

### FINISH

S.S 304, or M.S.

Mat or Mirror finish or

if M.S Powder coated

## DOUBLE FLOOR PLATFORM TROLLEY

## FIVE FLOOR PLATFORM TROLLEY

### APPLICATION

To carry different type of material

### LOAD CAPACITY

100 kg Per Self

### SIZE

1500 L X 600 D X 1630 MM HT

### FINISH

1.2 mm Thk CRC sheet with 4 stiffner at base & structure in rectangular pipe. Powder coated



### APPLICATION

To carry up to 60 mm thk & 600 mm Dia flanges

### LOAD CAPACITY

UP TO 500 kg max to total trolley

### SIZE

975 L X 600 D X 1000 MM HT

### WHEEL

Dia 100 x 35 mm thk  
Two wheel fix & two wheel swivel with brake

### FINISH

M S Powder Coated

## FLANGE TROLLEY



## SCRAP WIRE MESH TROLLEY

### APPLICATION

To carry scrap material

### LOAD CAPACITY

100 kg max

### SIZE

1000 L X 650 D X 1560 MM HT

### WHEEL

Dia 100 x 35 mm thk

Two wheel fix & two wheel swivel with brake

### PROPERTY

Upper door facility to open

Mesh Size: 3 mm dia X 25 x 25 sq. space

### FINISH

Powder Coated

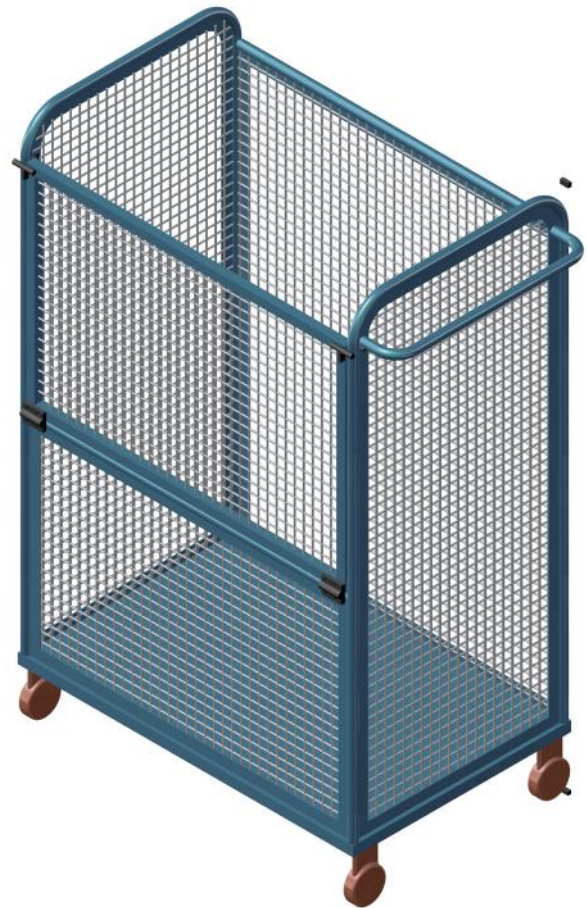

### APPLICATION

To pick & place material from height & for shop floor maintenance work

### LOAD CAPACITY

100 kg max

### STEPS

4, 5, 7, 8, 10

### HEIGHT

1050, 1300, 1550, 1800, 2050, 2550 (MM)

### FINISH

Powder Coated

## LADDER TROLLEY

## CNC A TYPE TOOL HOLDER TROLLEY

### APPLICATION

CNC Tool Storage & transportation of various tools

### LOAD CAPACITY

500 Kg UDL Max

### SIZE

640 L X 620 W X 1165 MM HT

### NO. OF LEVELS

9 Nos (4 nos either side & 1 no on top)

### WHEEL

Dia 150 x 40 thk  
Two fix & two swivel with brake

### FINISH

Powder Coated



### APPLICATION

CNC Tool Storage & transportation of various tools

### LOAD CAPACITY

500 Kg UDL Max

### SIZE

675 L x 490 W x 980 mm ht

### NO. OF LEVELS

5 Nos (1 nos either side & 3 nos on top)

### WHEEL

Dia 150 x 40 thk  
Two fix & two swivel with brake

### FINISH

Powder coated

## CNC SQUARE TYPE TOOL HOLDER TROLLEY

## OPERATOR PLATFORM

### APPLICATION

To mach height bet machine  
& operator

### SIZE

Customized size & Ht will be common 150 MM HT  
1000 L X 1000 W , 1200 L X 1200 W, 1400 L X 1400 W,  
1600 L X 1600 W , 2000 L X 2000 W

### ACCESSORIES

Adjustable Bush, M S Chequered Plate,  
Aluminum chequered plate, Wooden top

### FINISH

Powder Coated

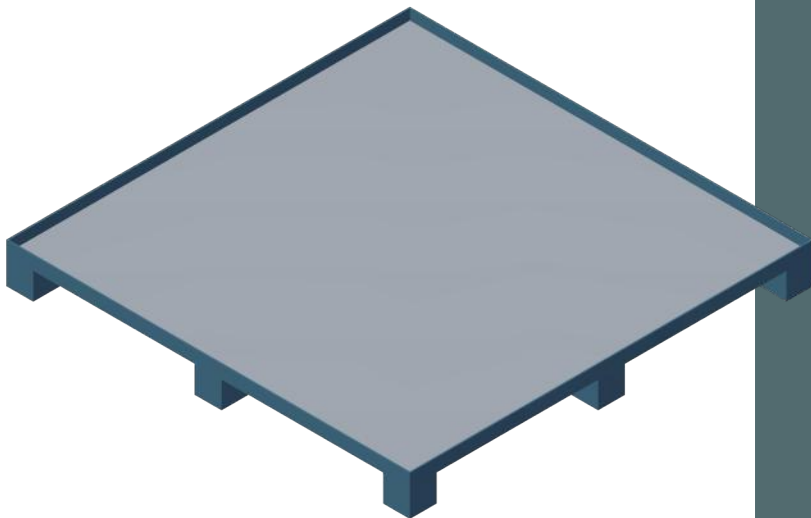
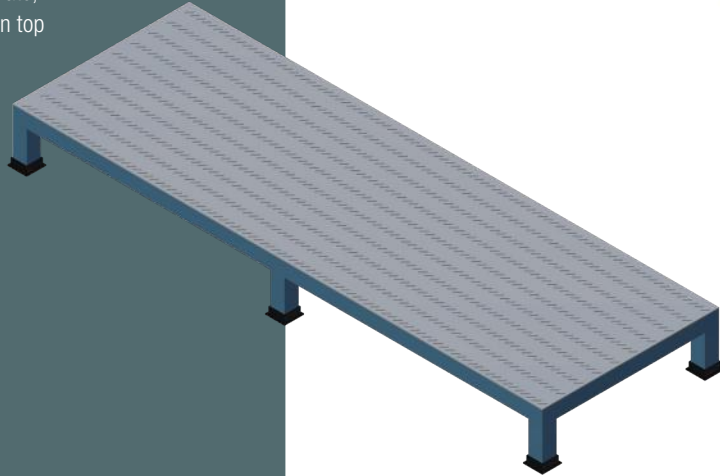

### APPLICATION

To keep heavy material & to move it in shop floor

### LOAD CAPACITY

7 Tons

### SIZE

1500 L X 1500 W X 150 MM HT

### ACCESSORIES

Rubber lining 2, 3, 4 mm thk Or Rubber Sheet

### FINISH

Powder coated

## FORKLIFT PALLET

## TILTING TYPE CHIP TROLLEY

### APPLICATION

Movement of chip & ease to access

### LOAD CAPACITY

250 kg Max Load UDL

500 Kg Max Load UDL

### SIZE

900 L X 600 W X 1000 MM HT

1300 L X 750 W X 1000 MM HT

### WHEEL

Dia 100 x 35 mm thk

Two wheel fix & two wheel swivel with brake

### FINISH

Powder coated

» Hand Operated  
Tilting Mechanism

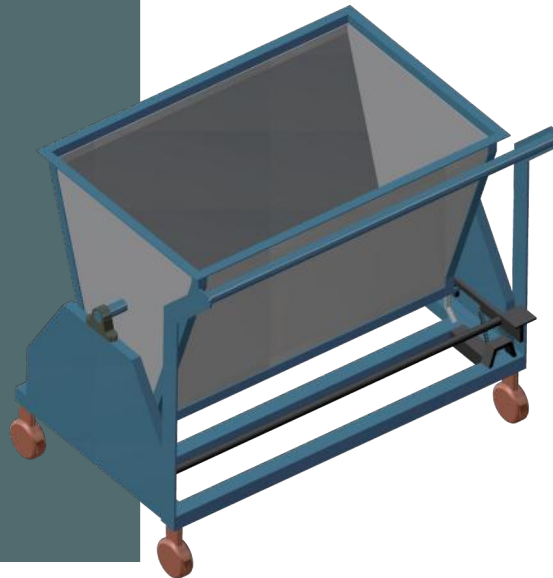
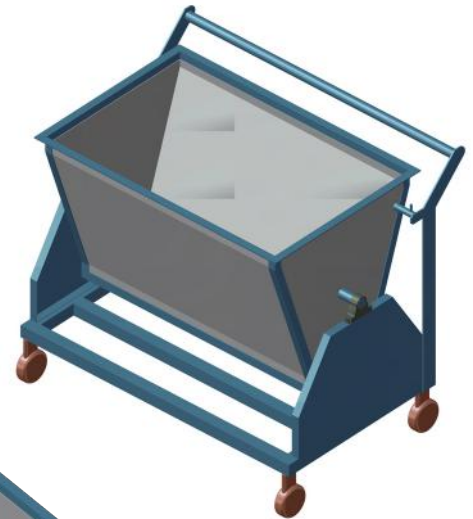

« Foot Operated  
Tilting Mechanism



### APPLICATION

To carry Coolant drum

### LOAD CAPACITY

Drum Dia 600 mm x 900 mm ht  
(300 Ltr Drum of Plastic)

### SIZE

1500 L X 900 W X 1030 MM HT

### WHEEL

Nylon Front wheel Dia 180 x 50 thk

Nylon Rear Wheel Dia 150 x 50 thk

### FINISH

Powder coated

## COOLANT DRUM HANDLING TROLLEY

## SLOTTED ANGLE RACK

### APPLICATION

For Storage at shop floor

### LOAD CAPACITY

100 KG , 150 KG, 200 KG PER SELF

### SIZE

900 L x 400 D x 2150 MM HT

5 self + 1at top

380 mm ht between two self

### ACCESSORIES

With three side cladding , OR Back side cladding

OR Without cladding

### FINISH

Powder coated

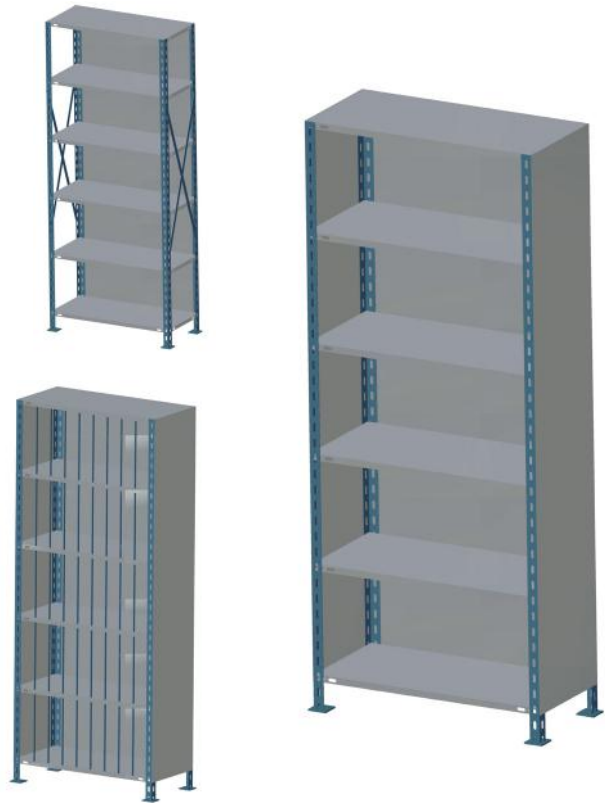

### APPLICATION

To carry gas cylinder

### LOAD CAPACITY

One cylinder

### SIZE

300 L X 350 W X 1500 MM HT

### WHEEL

Rubber Wheel Dia 125 x 50 mm Thk

### FINISH

Powder coated

## GAS CYLINDER TROLLEY



## SIMPLE STACKABLE PALLET

### APPLICATION

To Storage of material

### SIZE

680 L x 680 W x 900 mm ht & with stack 1000 mm ht  
1150 L x 1150 W x 1215 mm ht & with stack 1315 mm ht

### ACCESSORIES

Perforation Base & tray for oil leakage

### FINISH

Powder coated

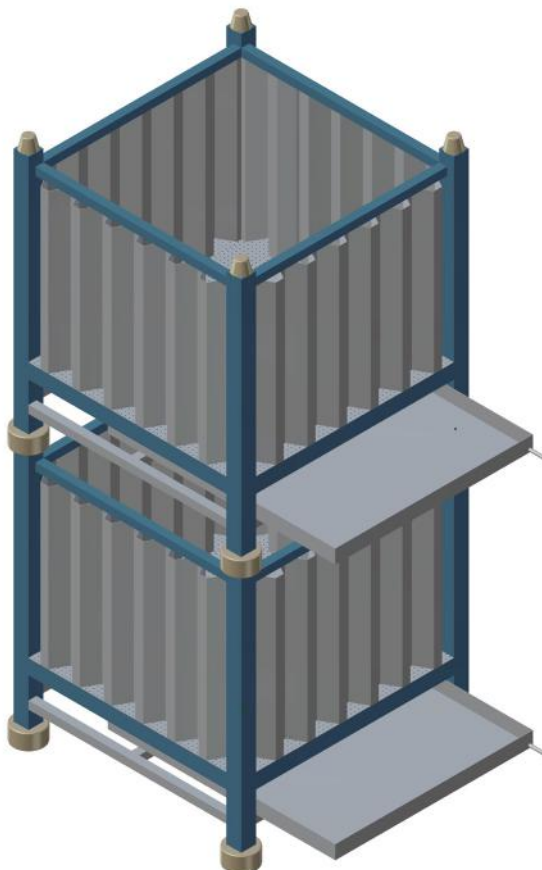
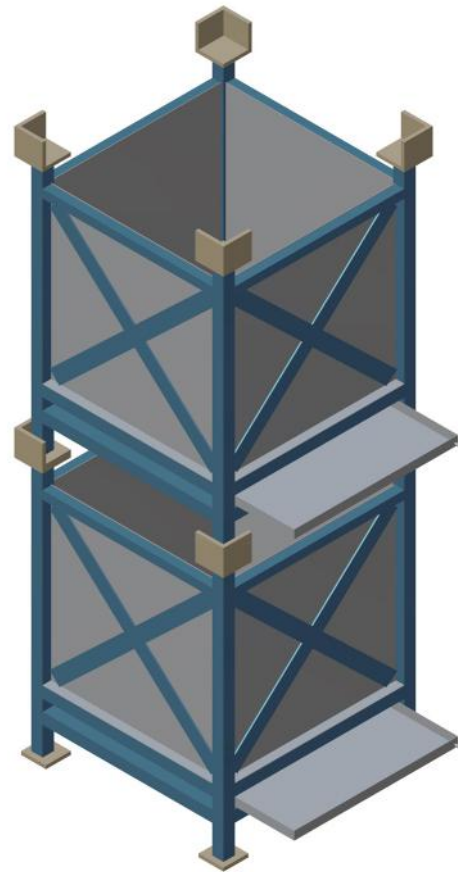
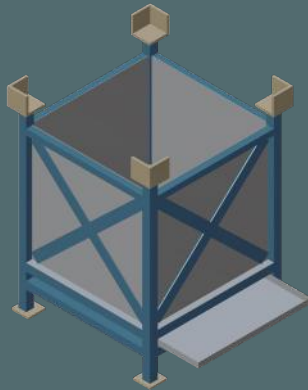

### APPLICATION

To Storage of material

### SIZE

680 L x 680 W x 900 mm ht & with stack 1000 mm ht  
1150 L x 1150 W x 1215 mm ht & with stack 1315 mm ht

### ACCESSORIES

Perforation Base & tray for oil leakage  
Also corrugated sheet on 4 sides

### FINISH

Powder coated

## STACKABLE PALLET WITH CORRUGATED SHEET

## WIRE MESH STACKABLE PALLET

### APPLICATION

To Store heavy equipments

### SIZE

1080 L X 1080 W X 1370 MM HT  
& WITH STACK 1510 MM HT

### ACCESSORIES

Upper door with hinges can open.  
Every three levels can be taken out.  
Mesh Size: - 1" x 1" x 3 mm thk Dia

### FINISH

Powder Coated

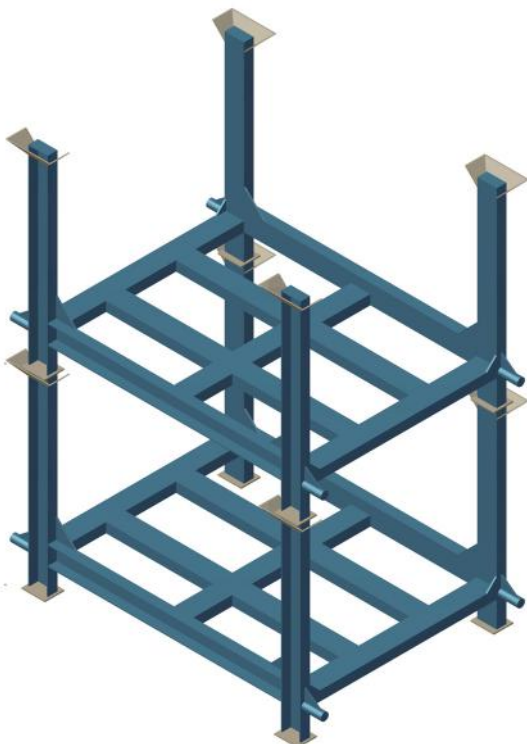
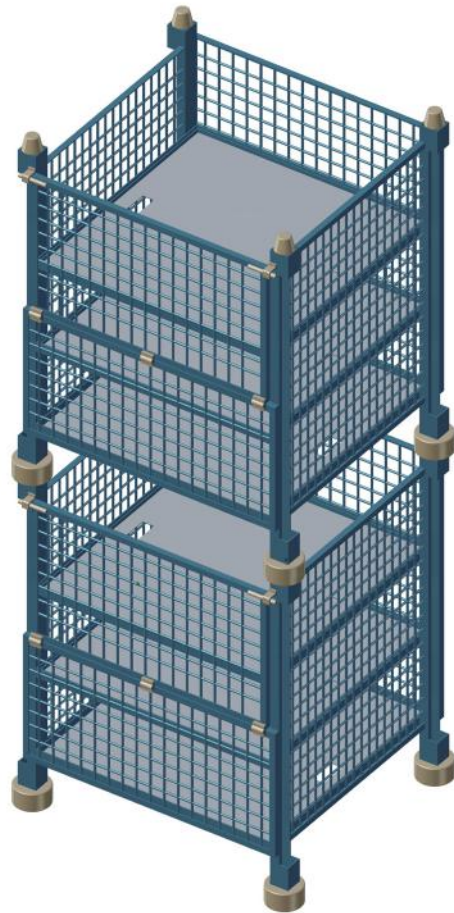

### APPLICATION

To Store roller / bar

### SIZE

1400 L X 1060 W X 980 MM HT &  
WITH STACK 1000 MM HT

### FINISH

Powder coated

## ROLLER / BAR STACKABLE PALLET

## LIBRARY CUPBOARD

### APPLICATION

For book storage or display of books

### SIZE

915 L X 485 D X 1980 MM HT

### SPECIFICATION

Inbuilt Locking System  
Ground clearance 150 mm ht  
Self are fix or adjustable  
Two door to open  
Glass front side so that books display easily

### FINISH

Powder Coated



### APPLICATION

For office general use

### TYPES & SIZE

» 4 SELF CUPBOARD

No Of Selfs: 4 self + 1 at bottom  
Overall Size: 915 L x 485 D x 1980 mm Ht

» 2 OR 3 SELF CUPBOARD

NO OF SELF: 2 OR 3 SELF + 1 AT BOTTOM  
OVERALL SIZE: 760 L X 430 D X 1300 MM HT

### SPECIFICATION

Inbuilt Locking System. Ground clearance 150 mm ht.  
Self are fix or adjustable. Two door to open

### FINISH

Powder coated

## OFFICE CUPBOARD

## FPO BIN STORAGE RACK

### APPLICATION

For Storage of BINS

### LOAD CAPACITY

100 KG , 150 KG, 200 KG PER SELF

### STEPS

» FOR ARISTO BIN NO. 45 (BLUE COLOUR )  
BIN SIZE: 215 L X 350 D X 200 MM HT  
RACK SIZE: 750 L X 400 D X 2150 MM HT  
TOTAL BINS:- 15 NOS PER SELF 3 NOS

» FOR ARISTO BIN NO. 35 (BLUE COLOUR )  
BIN SIZE: 210 L X 300 D X 160 MM HT  
RACK SIZE: 750 L X 400 D X 2150 MM HT  
TOTAL BINS: 15 NOS PER SELF 3 NOS

» FOR ARISTO BIN NO. 25 (BLUE COLOUR )  
BIN SIZE: 150 L X 225 D X 125 MM HT  
RACK SIZE: 700 L X 300 D X 1775 MM HT  
TOTAL BINS: 20 NOS PER SELF 4 NOS

» FOR ARISTO BIN NO. 15 (BLUE COLOUR )  
BIN SIZE: 120 L X 170 D X 85 MM HT  
RACK SIZE: 520 L X 250 D X 1575 MM HT  
TOTAL BINS: 20 NOS PER SELF 4 NOS

### SELF

5 SELF + 1 AT TOP

### FINISH

Powder Coated

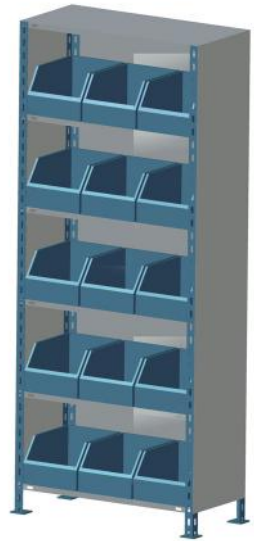

### APPLICATION

For keeping folder on shop floor & as well as works like a desk

### SIZE

Front height 975 mm HT  
Total Ht 1300 MM Ht & 670 L x 635 Depth wise

### FINISH

S S 202, S S 304  
Mat Finish Or Mirror Finish

## PODIUM STAND

## INDUSTRIAL WORKER LOCKER

### APPLICATION

Personal secured storage facility  
for every individuals

### OVERALL SIZE

36" L X 19" D X 78" HT (In MM = 915 L x 485 D x 1980 mm Ht)

### TYPES & SIZE

#### » 6 DOOR LOCKER

Door Arrangement: 3 Columns X 3 Rows  
Single Door Usable Area: 270 L x 875 mm Ht

#### » 6 DOOR LOCKER

Door Arrangement: 2 Columns X 3 Rows  
Single Door Usable Area: 415 L x 575 mm Ht

#### » 8 DOOR LOCKER

Door Arrangement: 2 Columns X 4 Rows  
Single Door Usable Area: 415 L x 425 mm Ht

#### » 9 DOOR LOCKER

Door Arrangement: 3 Columns X 3 Rows  
Single Door Usable Area: 270 L x 575 mm Ht

#### » 12 DOOR LOCKER

Door Arrangement: 3 Columns X 4 Rows  
Single Door Usable Area: 270 L x 425 mm Ht

#### » 12 DOOR LOCKER

Door Arrangement: 2 Columns X 6 Rows  
Single Door Usable Area: 415 L x 275 mm Ht

#### » 15 DOOR LOCKER

Door Arrangement: 3 Columns X 5 Rows  
Single Door Usable Area: 270 L x 355 mm Ht

#### » 18 DOOR LOCKER

Door Arrangement: 3 Columns X 6 Rows  
Single Door Usable Area: 270 L x 275 mm Ht



» 6 DOOR LOCKER



» 15 DOOR LOCKER





8 DOOR LOCKER



18 DOOR LOCKER



24 DOOR LOCKER

**Note** After 18 Door Locker Pigeon Hole Lockers Of 24,36,60 door lockers

#### **SPECIFICATION**

Inbuilt Or Staple Locking System. Ground clearance 150 mm ht. Name Plate on every door. Middle self & hangers if required.

#### **FINISH**

Powder coated

## WHITE BOARD STAND WITH BOARD

### APPLICATION

For display on shop floor,  
White Board One sided Or Two Sided

### SIZE

2520 L X 2050 MM HT

### ACCESSORIES

White Board Of Size:- 8' L x 5' HT  
( Size in MM= 2400 L x 1500 mm ht )

### WHEEL

50 mm Dia Two fix & two swivel with brake

### FINISH

Powder coated

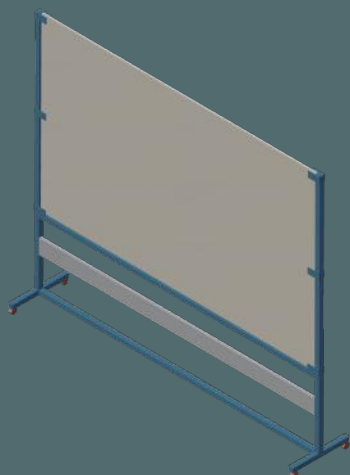

## SOFT BOARD STAND WITH BOARD

### APPLICATION

For display on shop floor

### SIZE

1920 L X 1900 MM HT

### ACCESSORIES

Soft Pin Board Of Size:- 6' L x 4' HT  
( Size in MM= 1800 L x 1200 mm ht )

### WHEEL

50 mm Dia Two fix & two swivel with brake  
Soft Pin Board One sided Or Two Sided

### FINISH

Powder coated



## PERFO CHAIR

### APPLICATION

For sitting on shop floor for machine operator

### SIZE

400 L x 400 W x 1200 mm Ht

### ACCESSORIES

Facility for foot rest.  
Perforation base & back

### FINISH

Powder coated



### APPLICATION

For sitting on shop floor for machine operator

### SIZE

400 DIA BASE X 630 MM HT

### ACCESSORIES

Facility for foot rest Perforation base

### FINISH

Powder coated

## PERFO STOOL

## FILE CABINET

### APPLICATION

For Storage of Tools &  
any other storage

### TYPES & SIZE

#### » 4 DRAWER FILE CABINET

Drawer Usable Area: 550 L x 300 mm ht  
Overall Size: 600 L x 465 D x 1300 mm Ht

#### » 3 DRAWER FILE CABINET

Drawer Usable Area: 550 L x 300 mm ht  
Overall Size: 600 L x 465 D x 1000 mm Ht

#### » 2 DRAWER FILE CABINET

Drawer Usable Area: 550 L x 300 mm ht  
Overall Size: 600 L x 465 D x 700 mm Ht

### SPECIFICATION

Name plate on every drawer. Single Locking System.  
Telescopic channel

### FINISH

Powder Coated

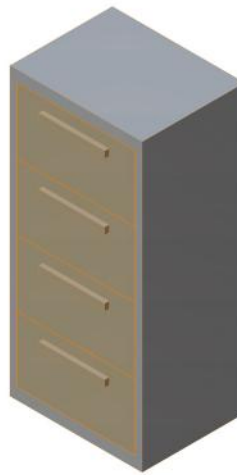

### APPLICATION

For Storage of Tools & any other storage

### SIZE

750 L X 465 D X 970 MM HT

### DRAWER

7 Nos Drawer

LAST DOWN 4 Nos Drawer, Size: 695 L x 90 mm ht.

LAST TWO drawers with ditch able partitions

UPWARD 3 Nos Drawer, Size: 695 L x 145 mm ht

### SPECIFICATION

Name plate on every drawer. Single Locking System.  
Telescopic channel

### FINISH

S S 202, S S 304

Mat Finish Or Mirror Finish

## TOOL CABINET

## A4 SIZE WI / DISPLAY STAND

### APPLICATION

For display in shop floor

### CAPACITY

10 Nos A4 size paper Folder can fit

### SIZE

Frame 350 HT x 85 L &  
Total Ht 1550 MM Ht

### ACCESSORIES

Rubber Bush & Height adjuster

### FINISH

Powder Coated

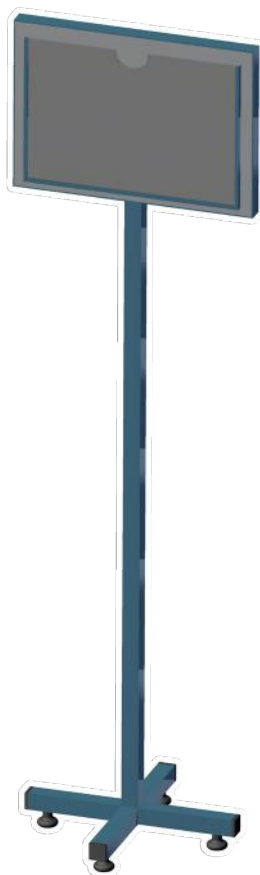
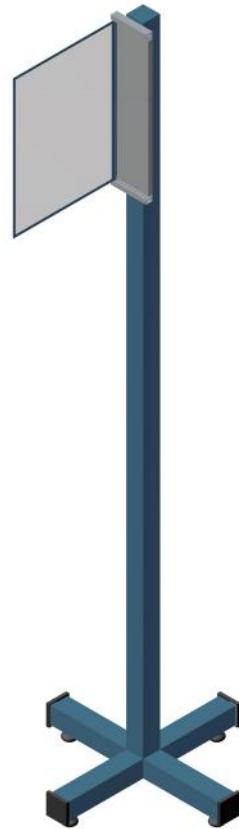

## A4 SIZE DISPLAY BOARD

### APPLICATION

For display in shop floor

### LOAD CAPACITY

A4 size paper can fit Hz. Only one paper

### SIZE

Frame 300 L x 250 mm ht &  
Total Ht 1200 MM Ht

### ACCESSORIES

Acrylic sheet on Front side & Height adjuster

### FINISH

Powder coated

## A4 SIZE DISPLAY BOARD

## ABOUT US

**Mr. Kiran Zambre** is a well-regarded veteran of the Indian engineering and manufacturing industry, highly respected for his attention to detail, strong work ethic and absolute refusal to compromise in his quality standards. Over a long and illustrious career, he has worked companies as diverse and capable as Eagle Burgmann India Pvt. Ltd. and

The skills and expertise Mr. Zambre has imbibed over this career is what became the driving force at Genious Engineering. With our highly skilled team of 25 employees, we endeavour to produce the best ergonomically right logistic solutions with high reliability, principled values and inflexible quality control.

Clients and customer satisfaction are more than just the goals at Genious Engineering, we work hard to delight them with our quality and expertise. This is why we have been consistently ranked among the best in the industry, and what spurs us to work ever harder to meet each one of our valued clients' demands.

**Mr. Kiran  
ZAMBARE**  
Managing Director





**OUR  
SATISFIED  
CUSTOMERS**



Enriching Lives



**EagleBurgmann.**  
Rely on excellence



**VIRGO™**



**Yapp**



# GENIOUS ENGINEERING

Turning ideas into reality

## REGISTER OFFICE

Office No. A 11, Bhosale Arcade, Near Vaibhav Cinema Hall,  
Pune - Solapur Road, Hadapsar, Pune – 411028.

## FACTORY

Gat No. 1311, Near Laxman Weight Bridge,  
Wadki, Pune Saswad Road, Pune – 412 308.

[WWW.GENIOUSENGINEERING.IN](http://WWW.GENIOUSENGINEERING.IN)

020 - 26825051

+ 91 - 976 769 2525

[info@geniousengineering.in](mailto:info@geniousengineering.in)